

HALDEN XS 40 INSTALLATION DRAWINGS



HOUSE: HALDEN XS 40

POS.	DESCRIPTION	NOTE	PCS.	PROFILE	LENGTH
AR5	IMPREGNATED FLOOR FRAMING		1	45x95	2575
AR4	IMPREGNATED FLOOR FRAMING	CUTOUT	1	45x95	2575
AR3	IMPREGNATED FLOOR FRAMING		8	45x95	1980
AR1	IMPREGNATED FLOOR FRAMING	CUTOUT	1	45x95	1980
AR2	IMPREGNATED FLOOR FRAMING		1	45x70	1980
PL-1	FLOOR BOARD		18+2	24x112	1965
KL-1	ROOF BOARD		25+3	24x112	2484
TL-1	IMPREGNATED TERRACE BOARD		17+2	28x120	500
PP-1	FLOOR/CEILING/ROOF MOULDING		11+1	15x55	2100
RLT-1	ROOF EDGE SUPPORT		2	45x45	2780
RL-1	ROOF EDGE BOARD		2	18x95	2600
RL-2	ROOF EDGE BOARD		2+1	18x95	2900
APL55-1	MOULDINGS FOR 845+845x1792 WINDOW	1 SET	2	15x55	1752
APL95-1			2	18x95	1650
APL95-2			2	18x95	1900
APL95-3			4	18x95	1877
UPL95-1	MOULDINGS FOR 690x1860 DOOR	1 SET	1	18x95	920
UPL95-2			2	18x95	1890
UPL-1	EXTRA MOULDING		2	18x95	2400

HOUSE: HALDEN XS 40

	DESCRIPTION	NOTE	PCS.
DOOR/WINDOW	EXTERIOR DOOR WITH WOODEN FRAME 88x690x1860		1
	WINDOW 45x845x1792		2
	DOOR HANDLE SET FOR EXTERIOR DOOR	WOODEN	1

	DESCRIPTION	NOTE	PCS.
COMPONENTS	BENCH MODULE 600x1992		1
	BENCH MODULE 400x1992		1
	BENCH SUPPORTS SET 45x45 (560-3PCS, 275-2PCS)		1
	ADDITIONAL VERTICAL BENCH SUPPORT 45x45x1000	ADJUSTABLE	1
	3MM SLOPE BOARD	1996MM	1
	6MM SLOPE BOARD	1996MM	1
	9MM SLOPE BOARD	1996MM	1
	12MM SLOPE BOARD	1996MM	1
	WOODEN VENTILATION LOUVER D100		2
	METAL VENTILATION GRID D100		2
	DRAINAGE 2000+	OPENS RIGHT	1

HOUSE: HALDEN XS 40

	DESCRIPTION	PCS.
FASTENERS	3.5x50 SCREW FOR FLOOR BOARDS	200
	3x40 STAINLESS SCREW FOR DOOR/WINDOW MOULDINGS	100
	4.2x55 STAINLESS SCREW FOR TERRACE AND ROOF EDGE BOARDS	200
	5x40 SCREW FOR ANGLE BRACKETS	40
	4.5x60 SCREW FOR ROOF EDGE SUPPORT	30
	4.5x70 SCREW FOR BENCH MODULES AND DOOR FRAME	50
	5x90 SCREW FOR FLOOR FRAMING AND CONNECTING WALL LOGS WITH FLOOR FRAMING	50
	6x120 SCREW FOR WALL LOG INTERSECTIONS	200
	6x180 SCREW FOR PURLINS, CONNECTING WALL LOGS WITH FLOOR FRAMING AND WALL LOGS	30
	75MM NAIL FOR ROOF BOARDS	250
	ANGLE BRACKET 40x40x40 FOR WINDOWS	6

BASE PLAN

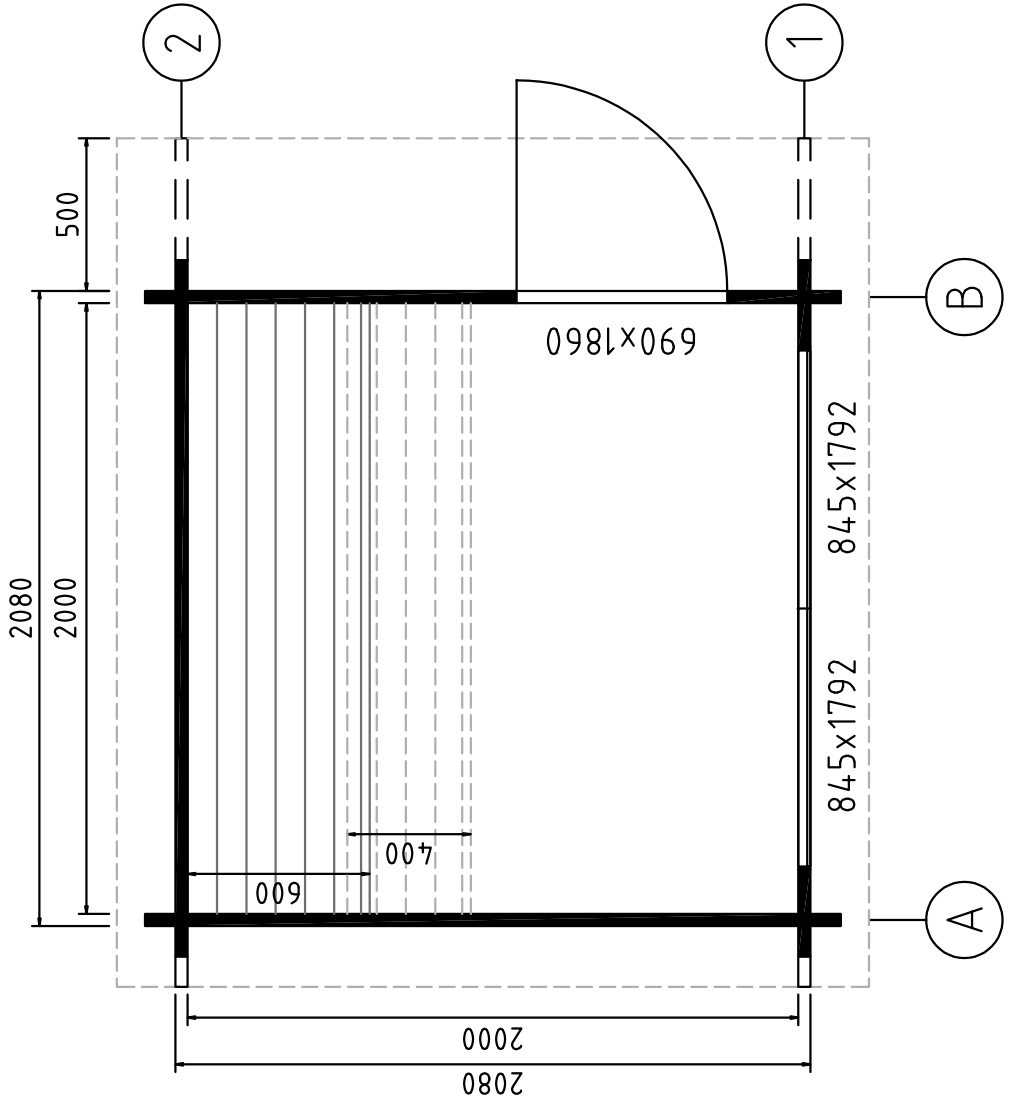

FLOOR FRAMING 45x95

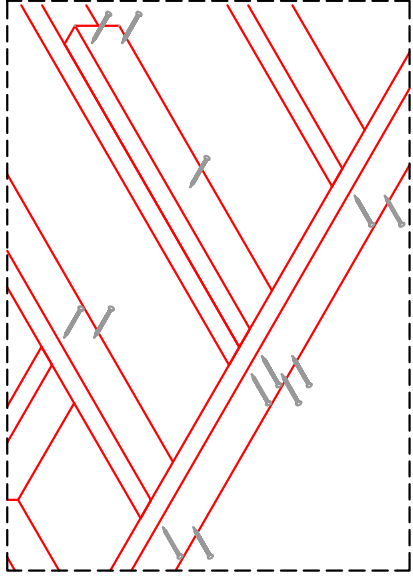
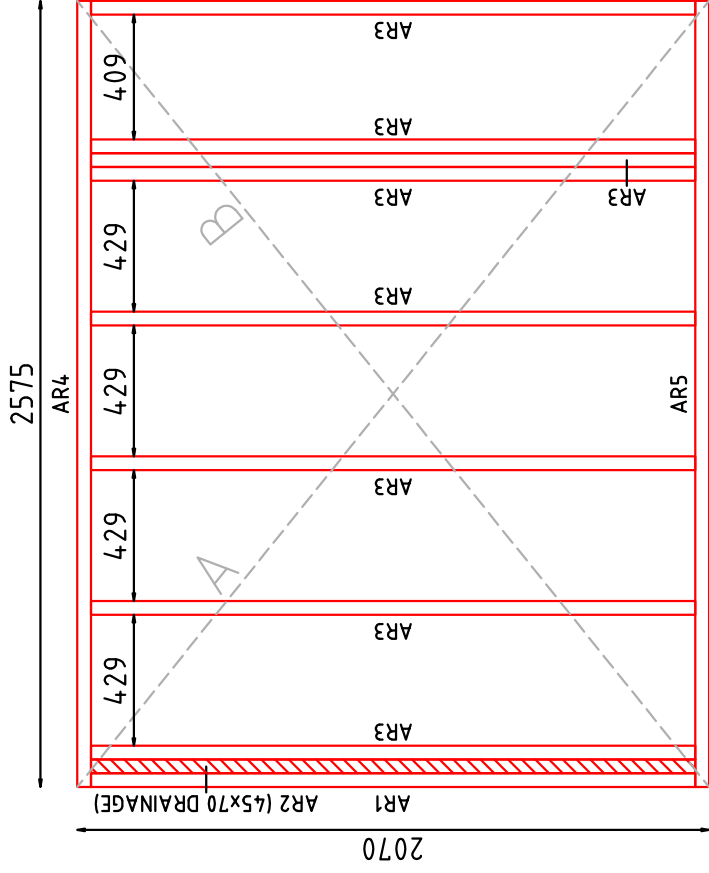

Use two 5x90 screws to fasten joist ends with crossing joists. Fix with parallel joists, when there is no crossing joists.

NB! Check diagonals, remember that $A=B=3304$

FASTENING WALL LOGS

Fasten first row to floor framing. Use 5x90 screws for half logs (fix those first) and 6x180 screws for full logs. It is recommended to predrill holes. If necessary use rubber hammer and hit block to secure logs tightly on top of each other.

Use 6x120 screws in each intersection. Try to alternate placement of drill holes so screws dont end up on top of each other. It is recommended to predrill the holes.

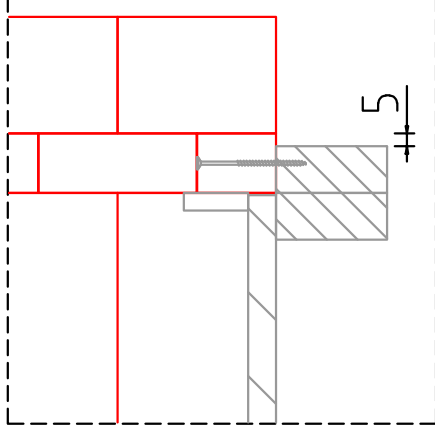
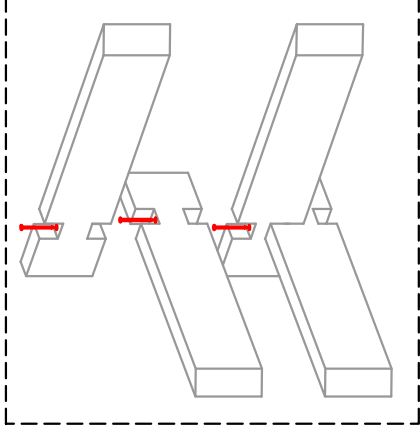
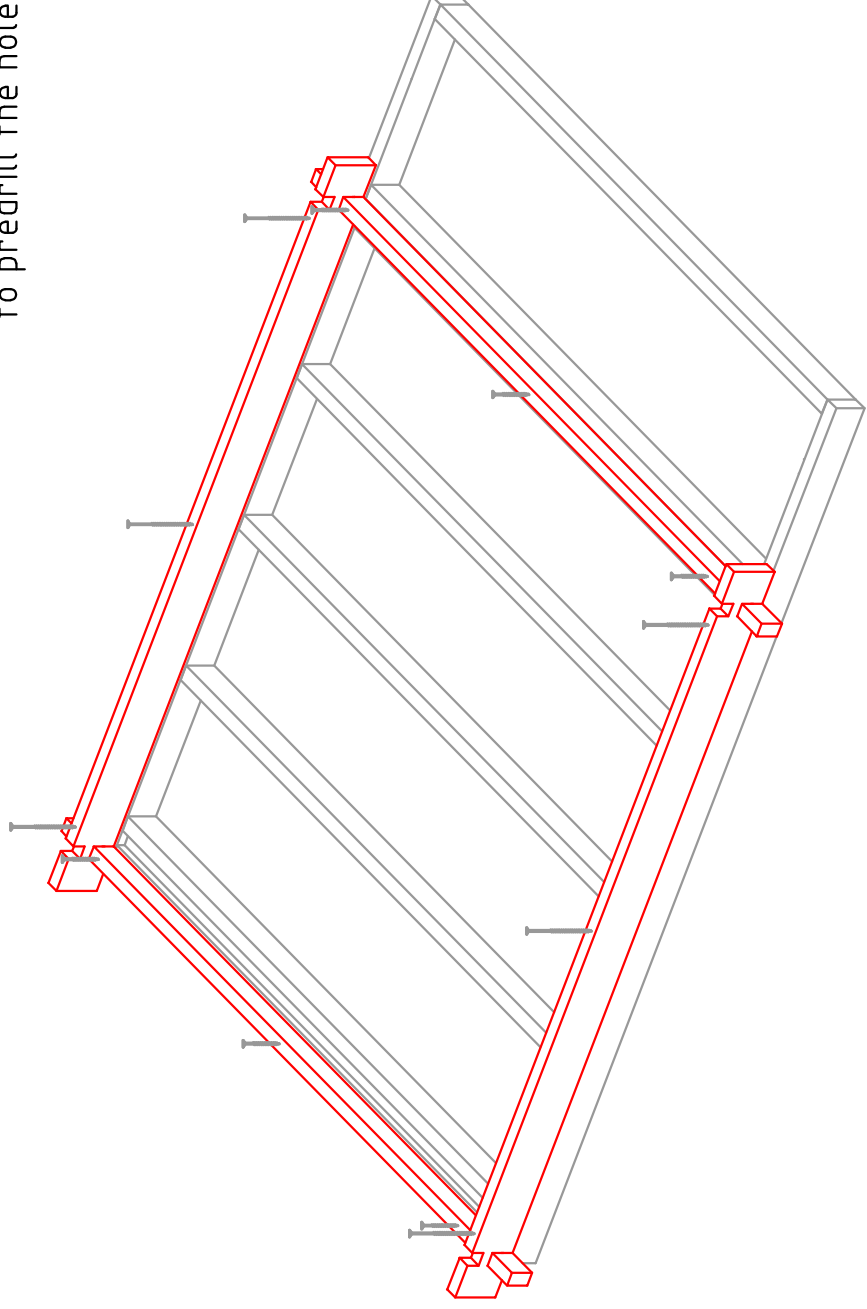

Framing should be 5mm inside from outer wall.

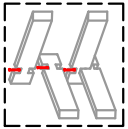

WALL A

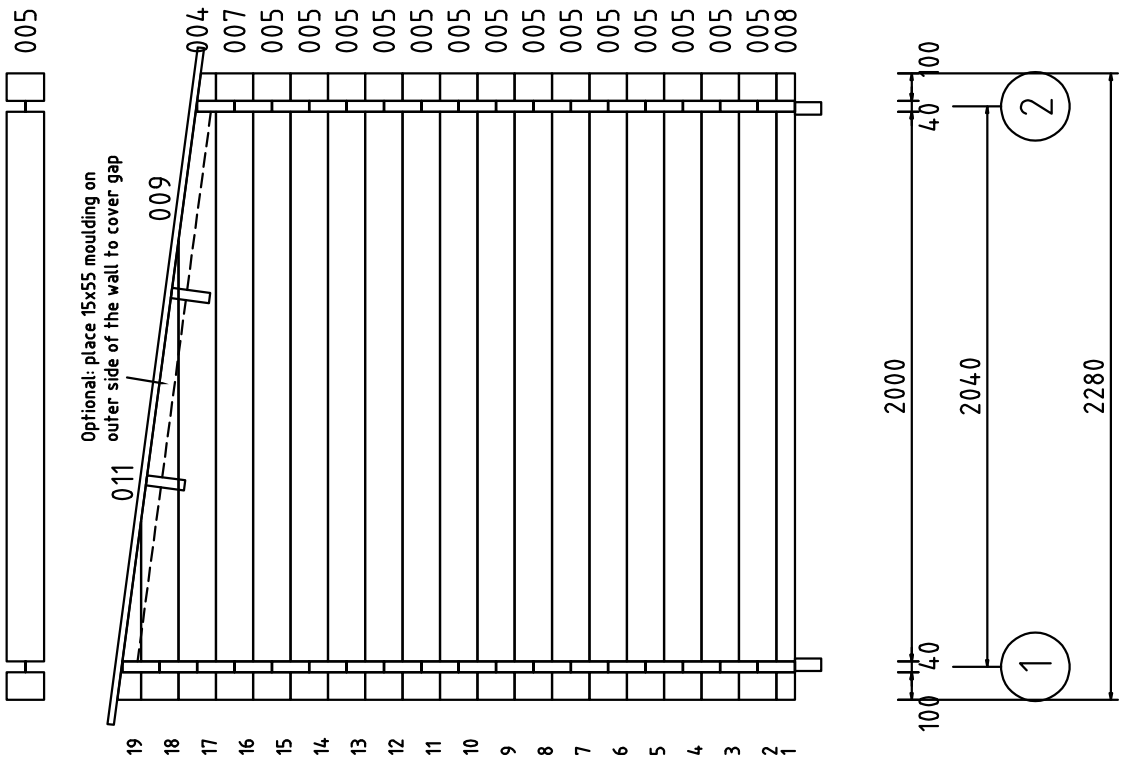

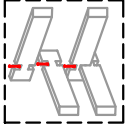

WALL B

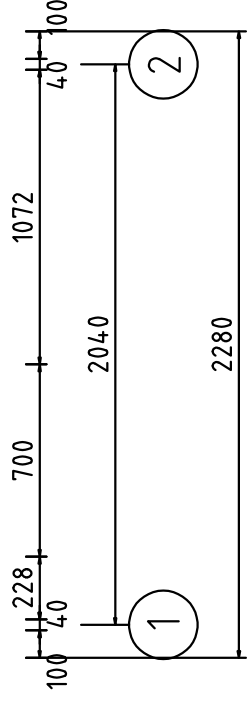
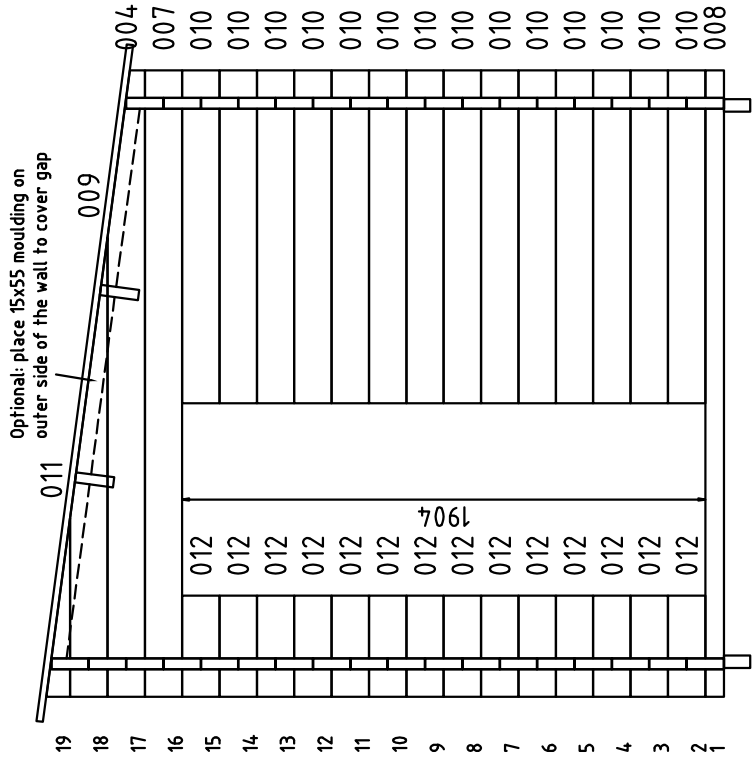

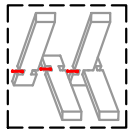

WALL 1

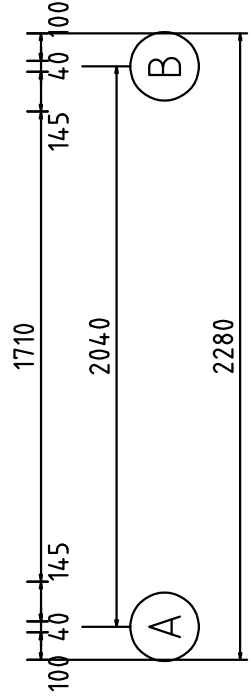
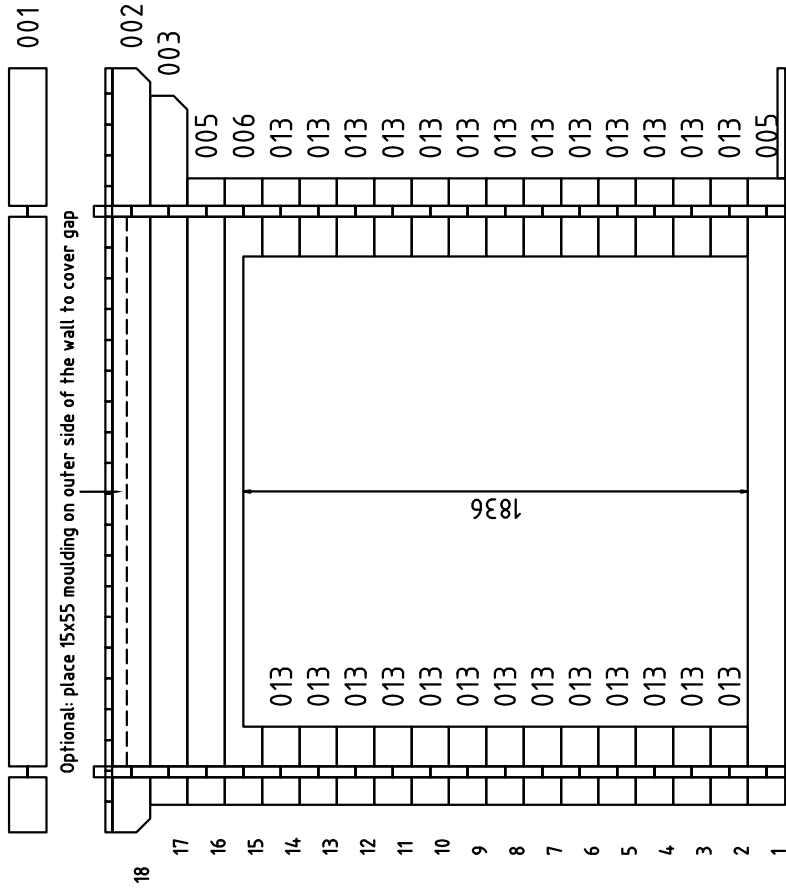

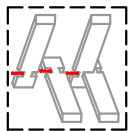

WALL 2

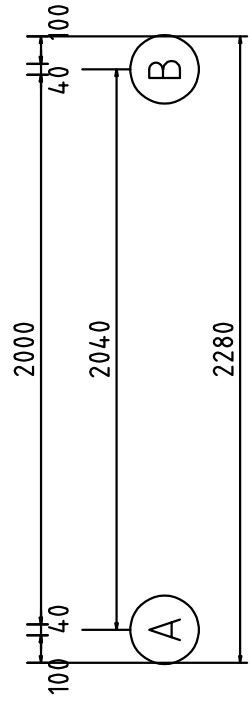
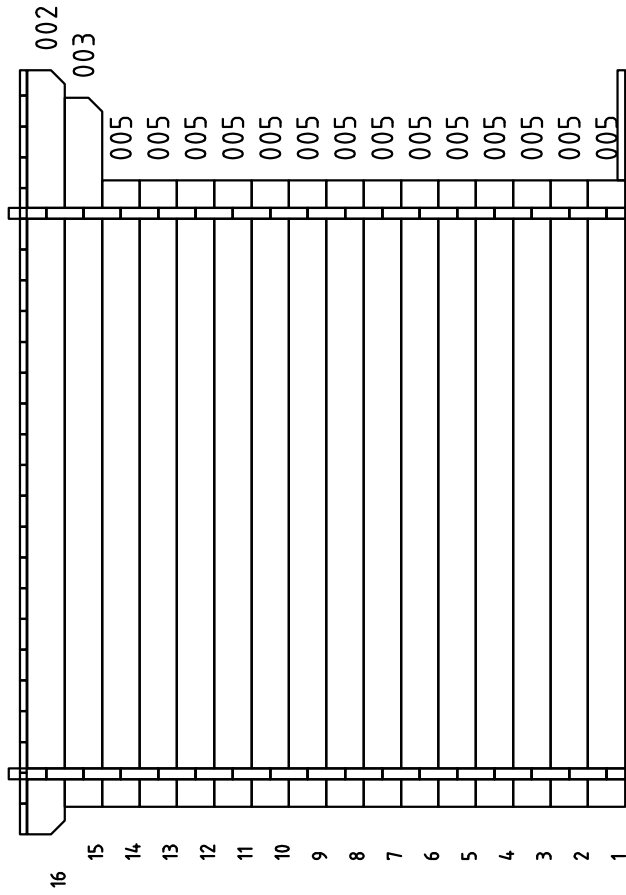

Add slope boards and drainage details before fixing floor boards.

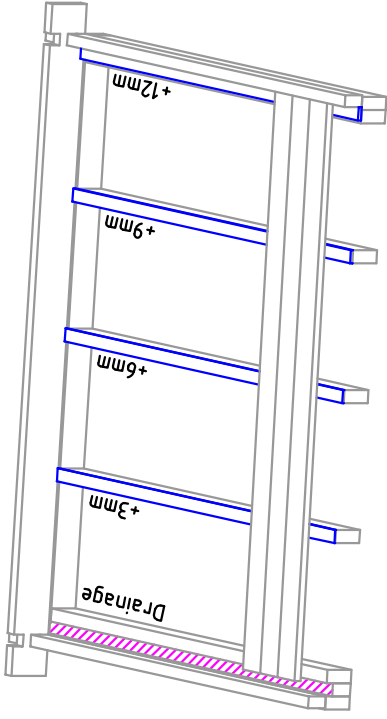

When placing drainage, fix closed end temporarily ~5mm higher than opened end to guarantee slope towards outer wall for water. After placing floor boards fix it permanently with floor mouldings.

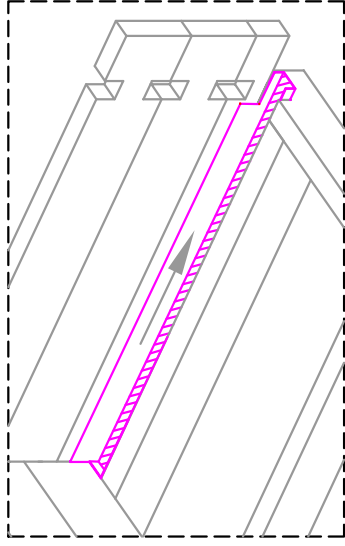

FLOOR BOARDS

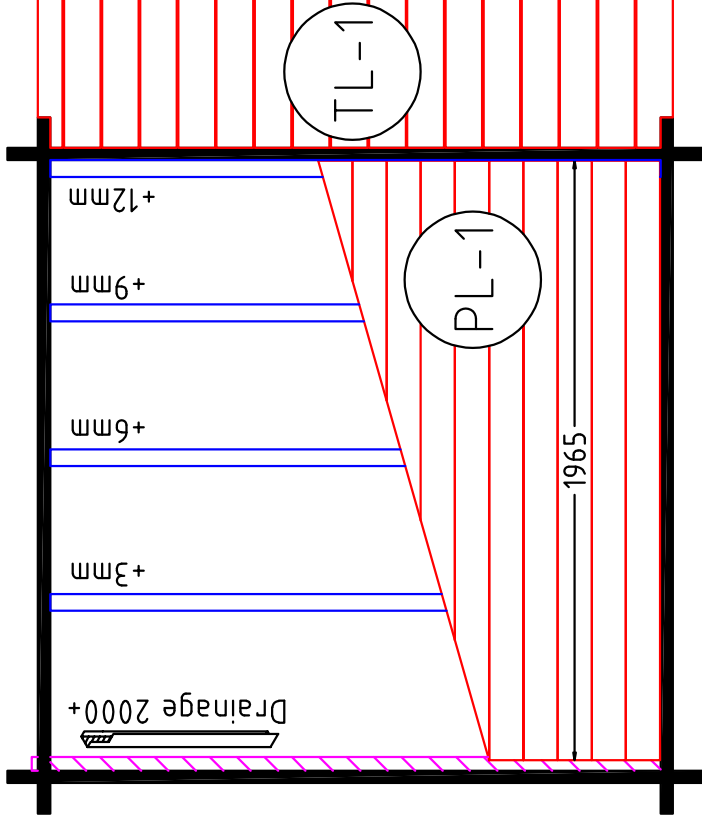

Fasten floor boards with screws from the tongue side of the board. First board should be placed ~5mm from wall and when cutting last board make sure there is 5mm gap as well. Leave ~2mm gap between floor board (cross cut sides) and walls. Lastly fix mouldings in place.

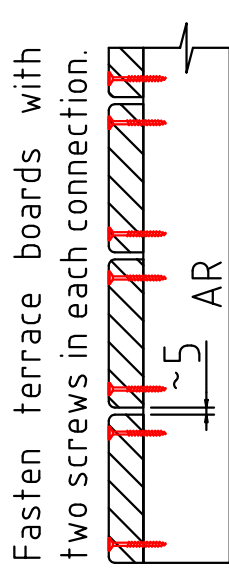
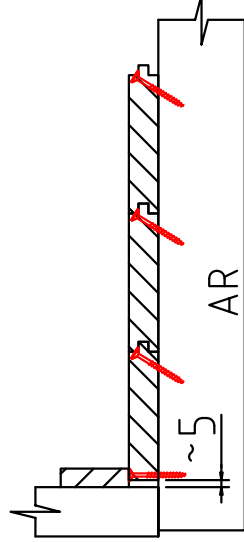

ROOF BOARDS

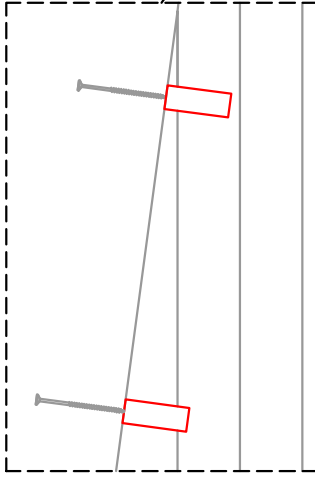

1. Fix purlins with 6x180 screws (pre-drill holes).

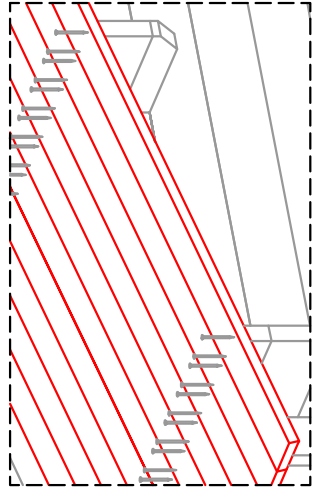

2. Fix roof boards with 75mm nails (2pcs for each connection).

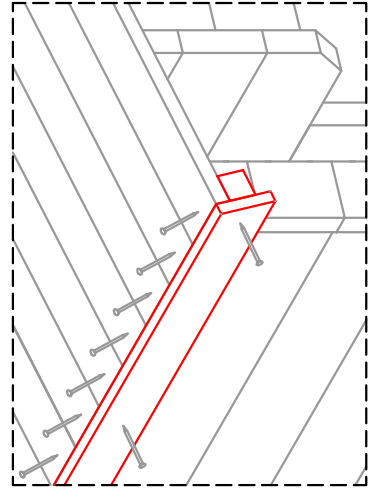
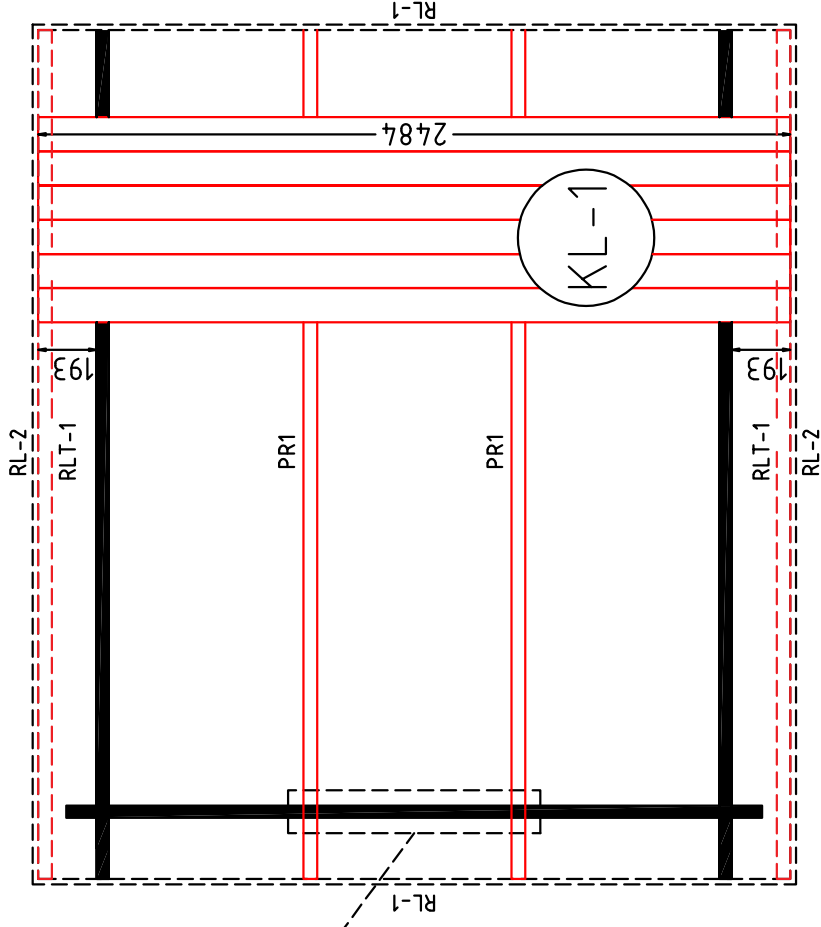

3. Fasten roof edge support and board. Use 4,5x60 screws (one for every other board ending) to fix edge support. For edge boards use 4,2x55 screws.

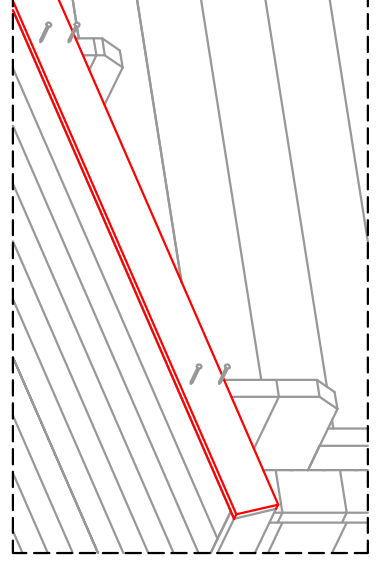

4. Cut gable edge boards to length and fix with 4,2x55 screws.

FASTENING DOORS/WINDOWS

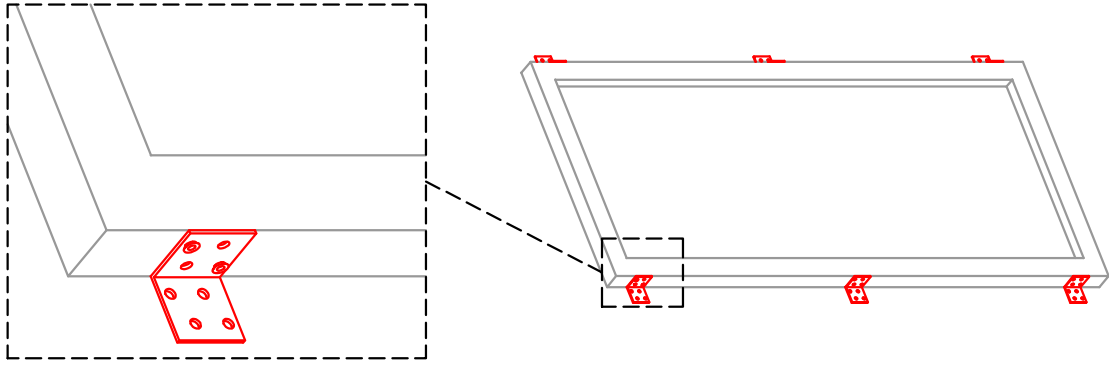

1. Fasten 40x40x40 angle brackets to window jambs (3pcs for each side) with two 5x40 screws. Make sure that brackets are 3mm inside from outer surface of the jamb, so there will be enough room for screw heads when mounting windows to walls and fixing mouldings.

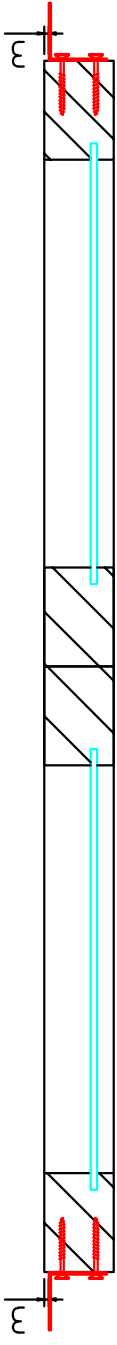

2. Lift window in place and fasten angle brackets to wall with 5x40 screws (2pcs for each bracket).

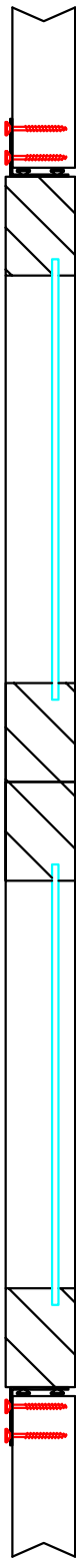

3. Fasten mouldings with 3x40 screws. Mouldings should cover about 20mm of frame.

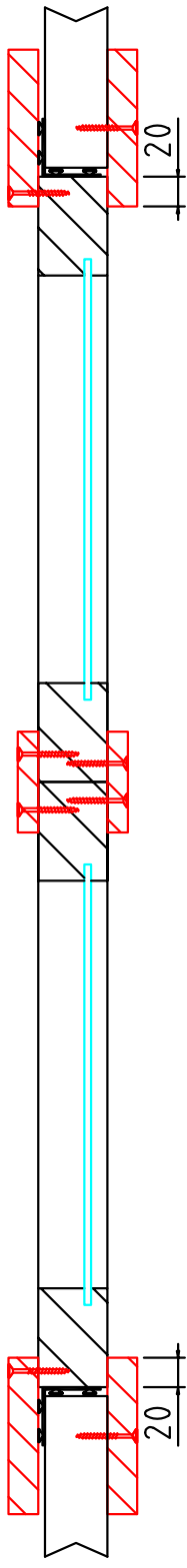

1. Lift door in place and fix it to wall by screwing 4,5x70 screws through wall to frame.

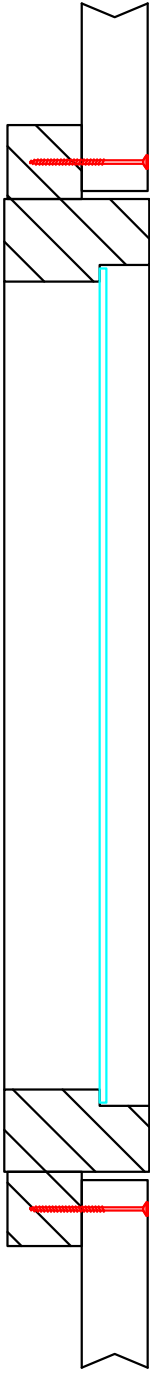

2. Fasten mouldings with 3x40 screws. Mouldings coverage is about 20mm on upper moulding and 10mm on sides. There are no mouldings on the side of the frame.

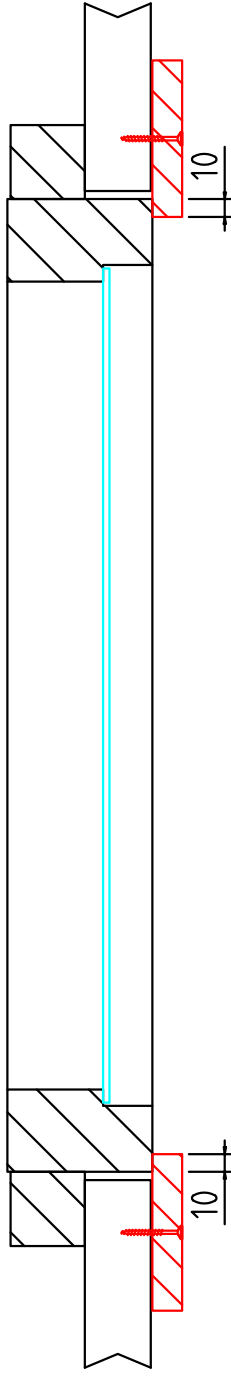

DOOR/WINDOW MOULDINGS

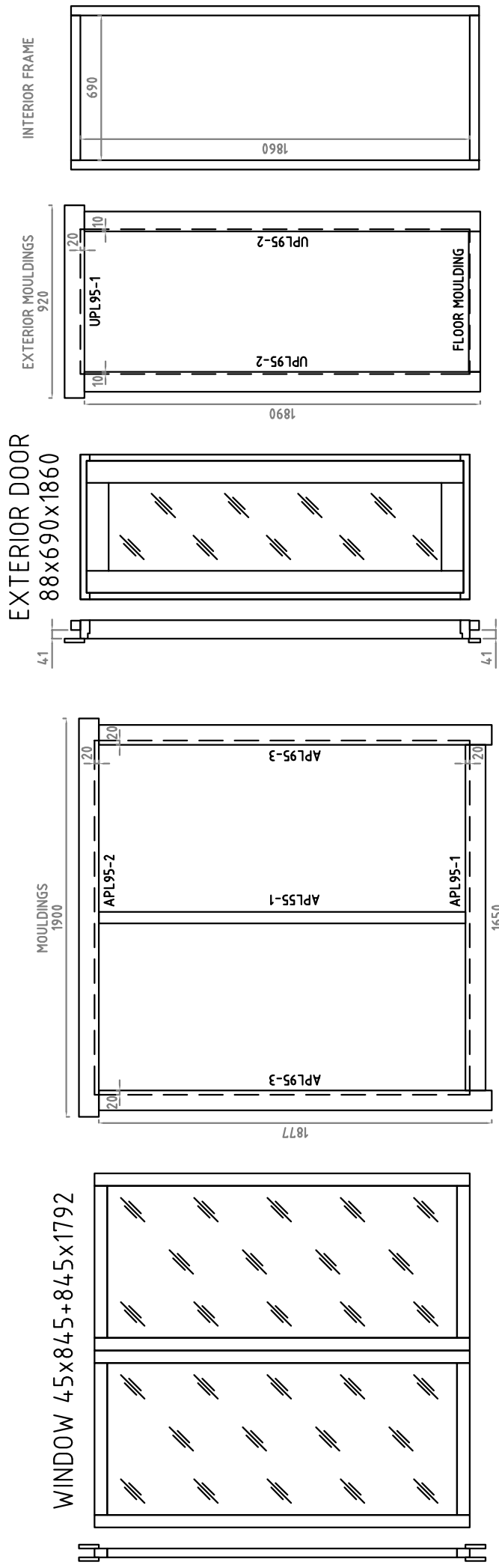

FASTENING BENCH MODULES

This is an overall manual for bench modules. You can skip some of the steps depending on the set (for example if there is no bench skirt). Precise heights for bench supports and benches can be found on the next page.

1. Fasten bench supports with screws to wall. Use glue between wall and support for stronger connection.

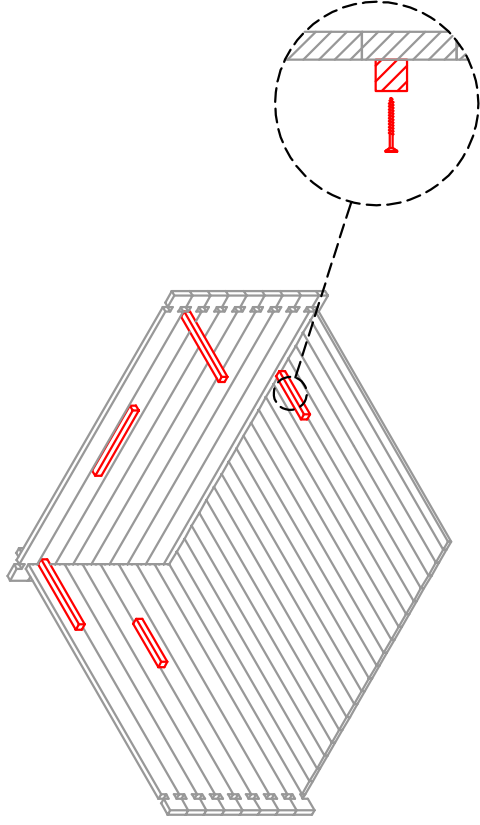

3. Lift bench skirt in place, attach it to wall from sides and to lower bench in middle. There should be 8mm gap between lower bench and bench skirt.

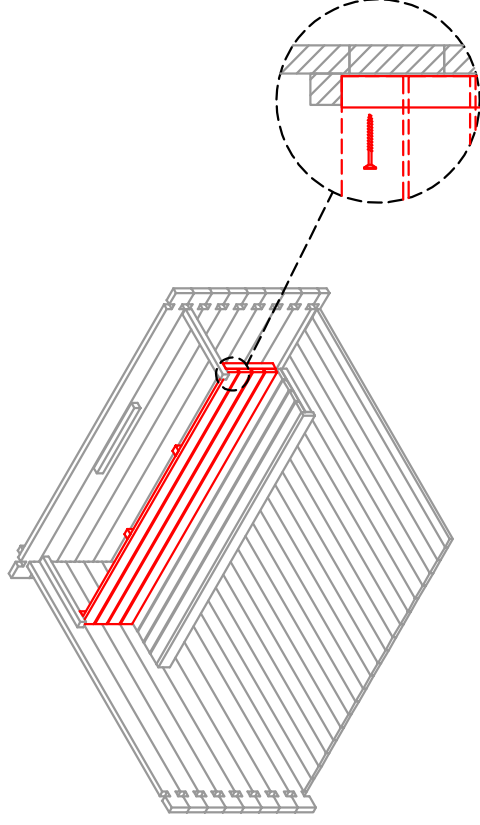

2. Lift modules in place and fix them to the supports on the walls. Do not install upper module in case there is bench skirt in set.

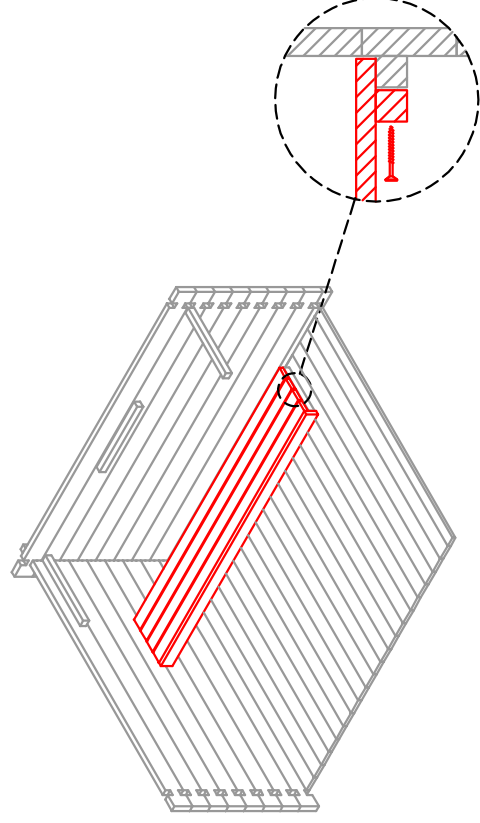

4. Place upper module and fix it in place as described in step two.

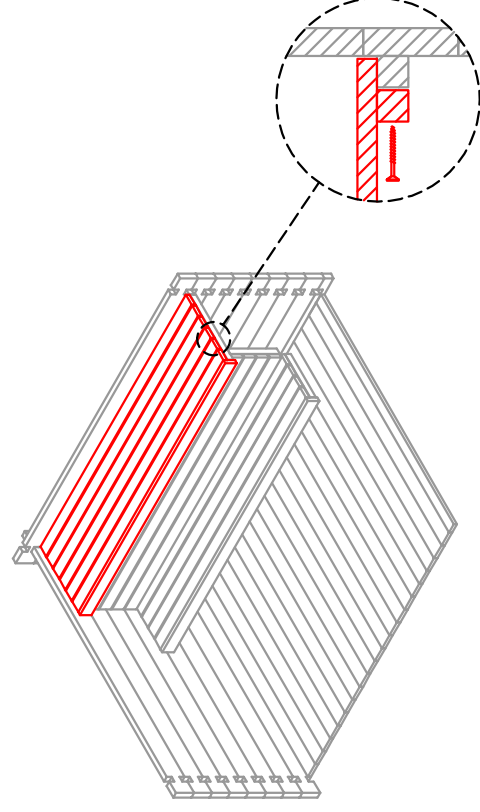

CROSS-SECTION OF SAUNA ROOM AND HEIGHT OF BENCH MODULES

Use 4,5x70 screws to fasten bench supports to walls and to fix benches to already fixed supports. Lower module position is approximate (can be placed according to your own preference).

